



## SPECIFICATION

RATING	: 15A 250VAC (UL,C-UL) 10A 250V~ (ENEC)
INSULATION RESISTANCE	: DC 500V 100MΩ OR MORE
WITHSTAND VOLTAGE	: AC 1500V FOR 1 Min
NOTE	: ROCKER SWITCH 3024/3026

Standards: IEC60320/C14

### 3544 SERIES

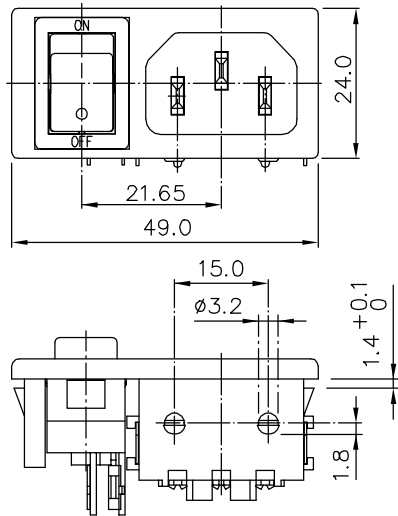

### T1B01

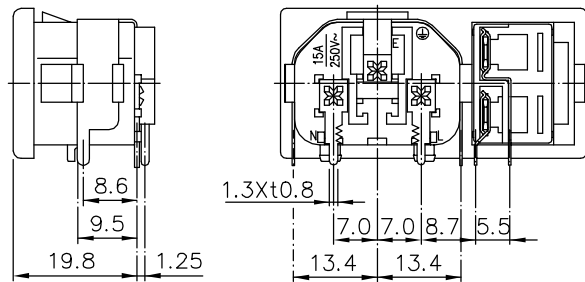

### T2B01

